

GSCL-360

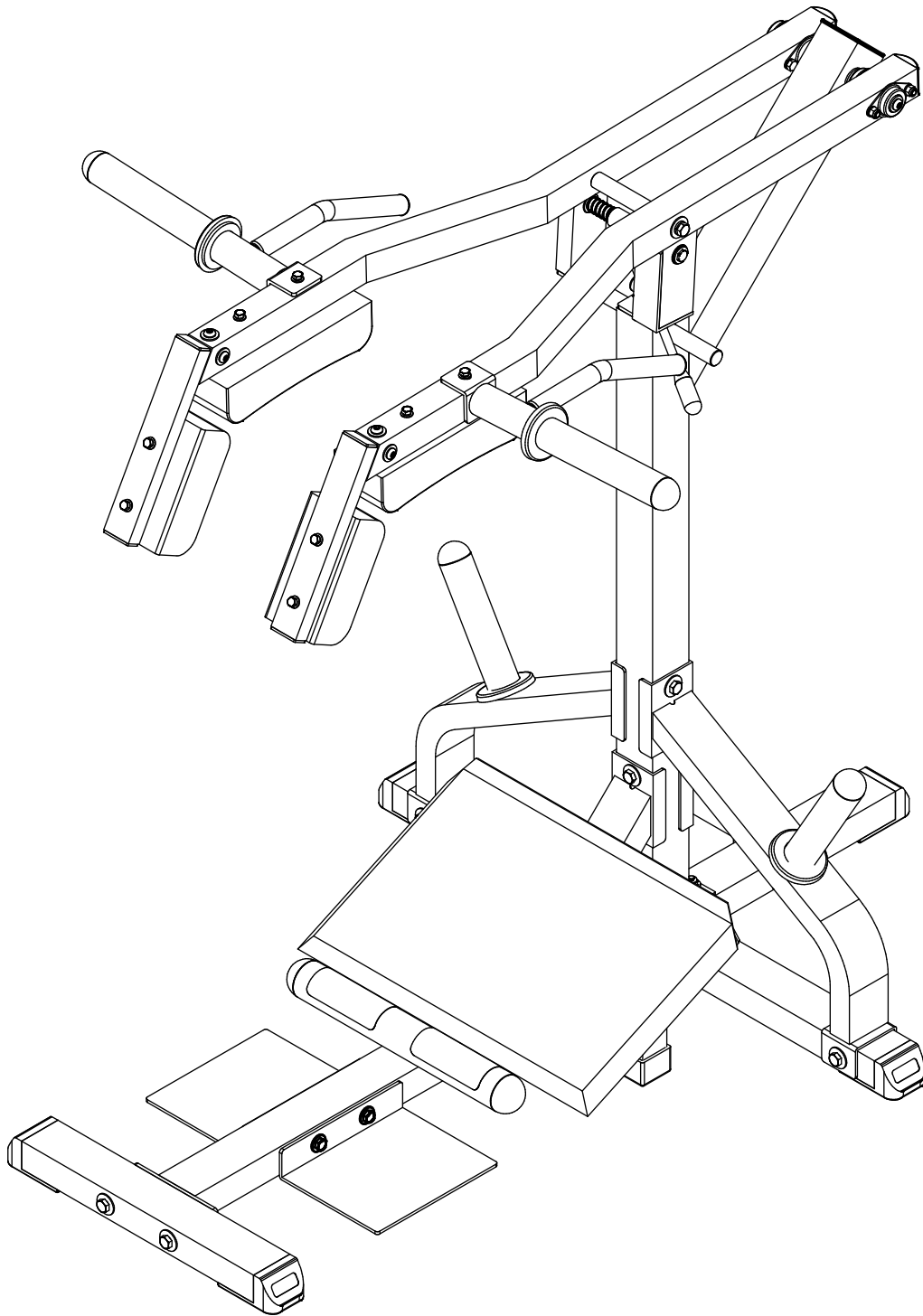

VERSION 0210

GSCCL-360

HARDWARE ILLUSTRATION SHEET

| | Qty. |
|-----------------------------------------------|---------|
| A1. M12x100 HEX HEAD BOLT | [12PCS] |
| A2. M10x100 HEX HEAD BOLT | [2PCS] |
| A3. M10x70 CARRIAGE BOLT | [2PCS] |
| A4. M8x70 HEX HEAD BOLT | [2PCS] |
| A5. M8x65 HEX HEAD BOLT | [2PCS] |
| A6. M8x40 HEX HEAD BOLT | [4PCS] |
| A7. 3/8"x2 3/4" HEX HEAD BOLT (pre-installed) | [4PCS] |
| A8. M12x25 HEX HEAD BOLT (pre-installed) | [2PCS] |
| A9. M12x70 HEX HEAD BOLT (pre-installed) | [2PCS] |
| A10. M10x16 ROUND BOLT (pre-installed) | [10PCS] |
| B1. M12 NYLON LOCK NUT | [12PCS] |
| B2. M10 NYLON LOCK NUT | [4PCS] |
| B3. 3/8" NYLON LOCK NUT (pre-installed) | [4PCS] |
| C1. M12 (I.D) WASHER (4 are pre-installed) | [28PCS] |
| C2. M10 (I.D) WASHER (10 are pre-installed) | [16PCS] |
| C3. M8 (I.D) WASHER | [8PCS] |
| C4. M8 SPRING WASHER | [8PCS] |
| C5. 3/8" (I.D) WASHER (pre-installed) | [8PCS] |
| C6. M20 (I.D) WASHER (pre-installed) | [2PCS] |
| C7. M12 SPRING WASHER (pre-installed) | [2PCS] |

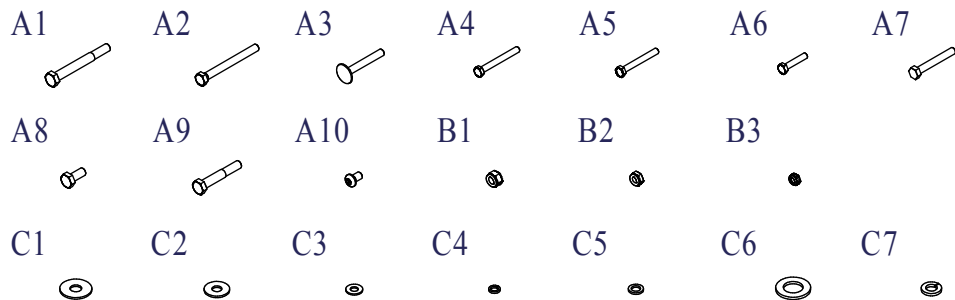

PARTS ILLUSTRATION SHEET

| | Qty. |
|--------------------------------------------------------|--------|
| D1. 2"x2" PLASTIC COVER (9310-020) | [2PCS] |
| D2. 50x50 END CAP (9211-087) | [2PCS] |
| D4. 25x50 END CAP (9211-086) | [8PCS] |
| D5. Ø1" ROUND END CAP (9211-021) | [2PCS] |
| D6. Ø49.5 ROUND END CAP (9211-074) | [4PCS] |
| D7. 50x75 FOOT CAP (9211-025) | [5PCS] |
| D8. Ø60 ROUND END CAP (9211-075) | [2PCS] |
| D9. 50x75 RUBBER DOUNT (9212-011) | [1PCS] |
| D10. Ø90x10t RUBBER DOUNT (9310-016) | [4PCS] |
| D11. NON SKID TAPE (9630-003) | [2PCS] |
| D12. Ø20x1.5x70L STEEL SPRINGS (8840-012) | [1PCS] |
| D13. STORAGE PIN (8220-086) | [1PCS] |
| D14. OILITE BUSHING Ø20xØ26 (8520-003) (pre-installed) | [2PCS] |
| E1. BEARING 6004zz (pre-installed) | [4PCS] |

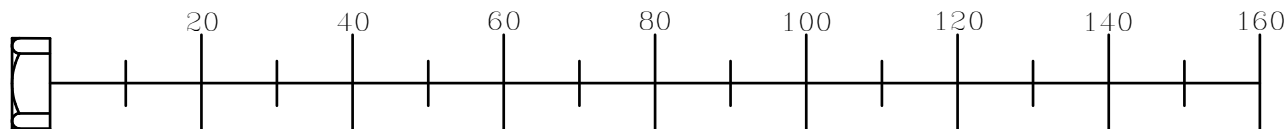
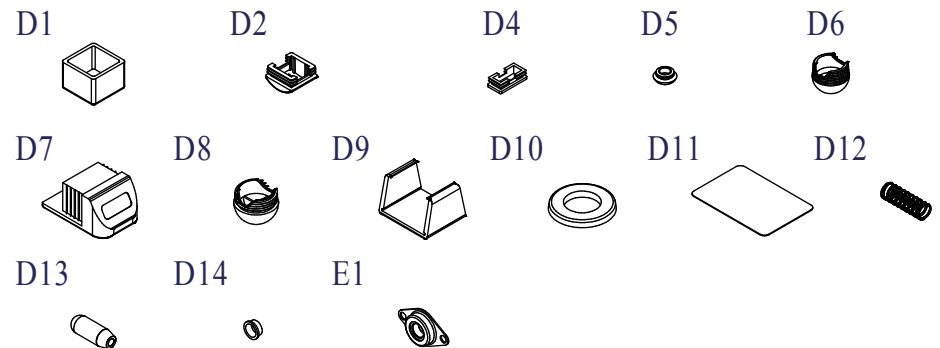

GSCL-360 PARTS ILLUSTRATION SHEET

A [1PCS]

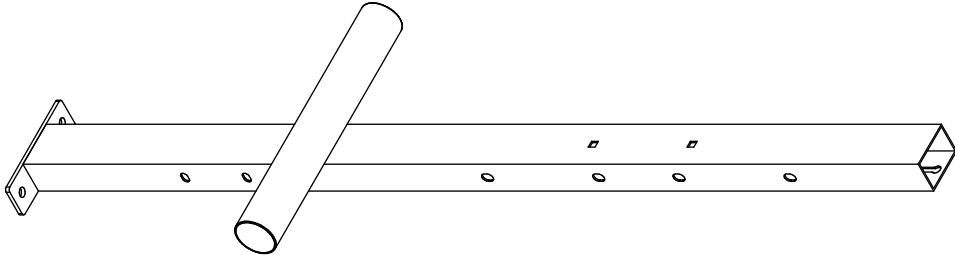

C [1PCS]

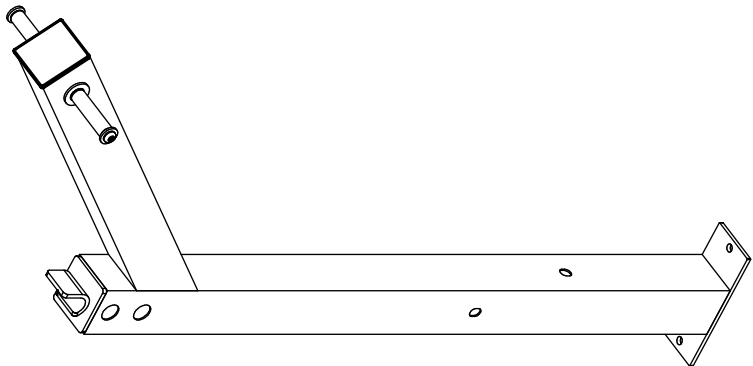

B [2PCS]

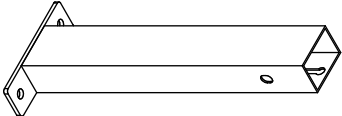

D [2PCS]

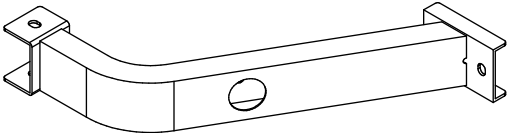

E [1PCS]

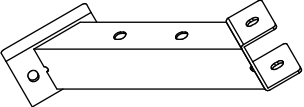

F [1PCS]

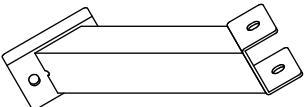

H [1PCS]

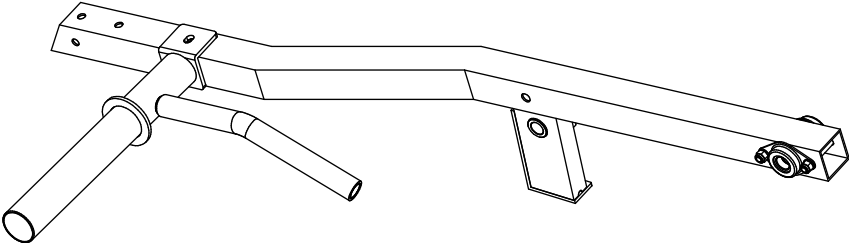

G [1PCS]

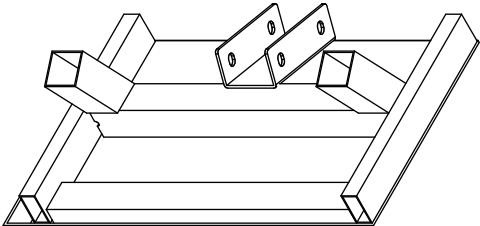

I [1PCS]

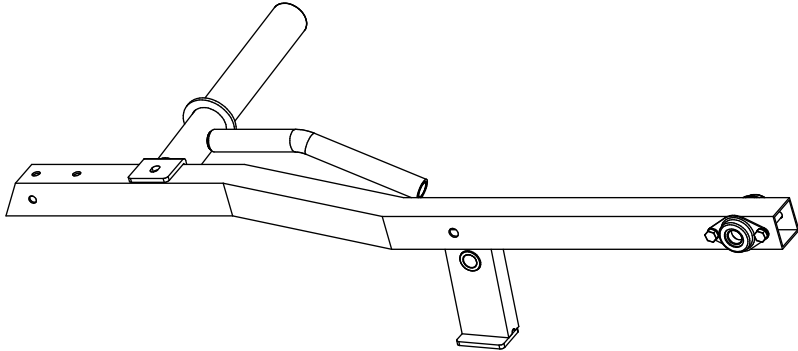

GSCL-360 PARTS ILLUSTRATION SHEET

J [2PCS]

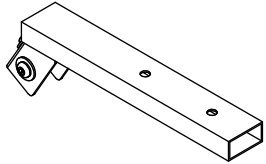

K [2PCS]

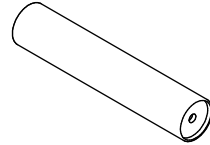

L [1PCS]

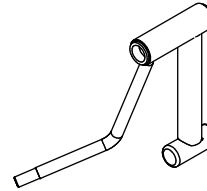

S [1PCS]
8210-058

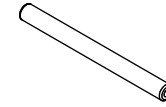

M [1PCS]

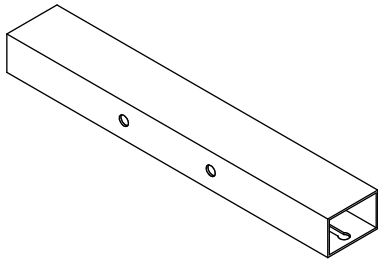

N [1PCS]
8220-094

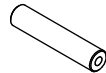

O [1PCS]
8220-087

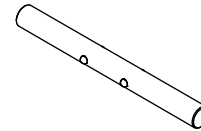

P [2PCS]

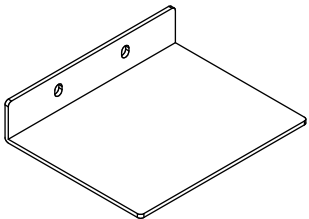

Q [2PCS]
9133-001

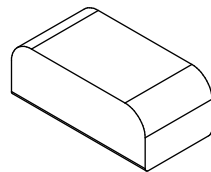

R [2PCS]
9133-002

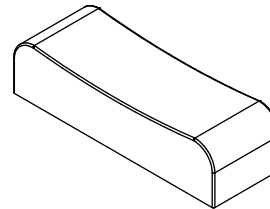

GSCL-360

Assembly Step 1

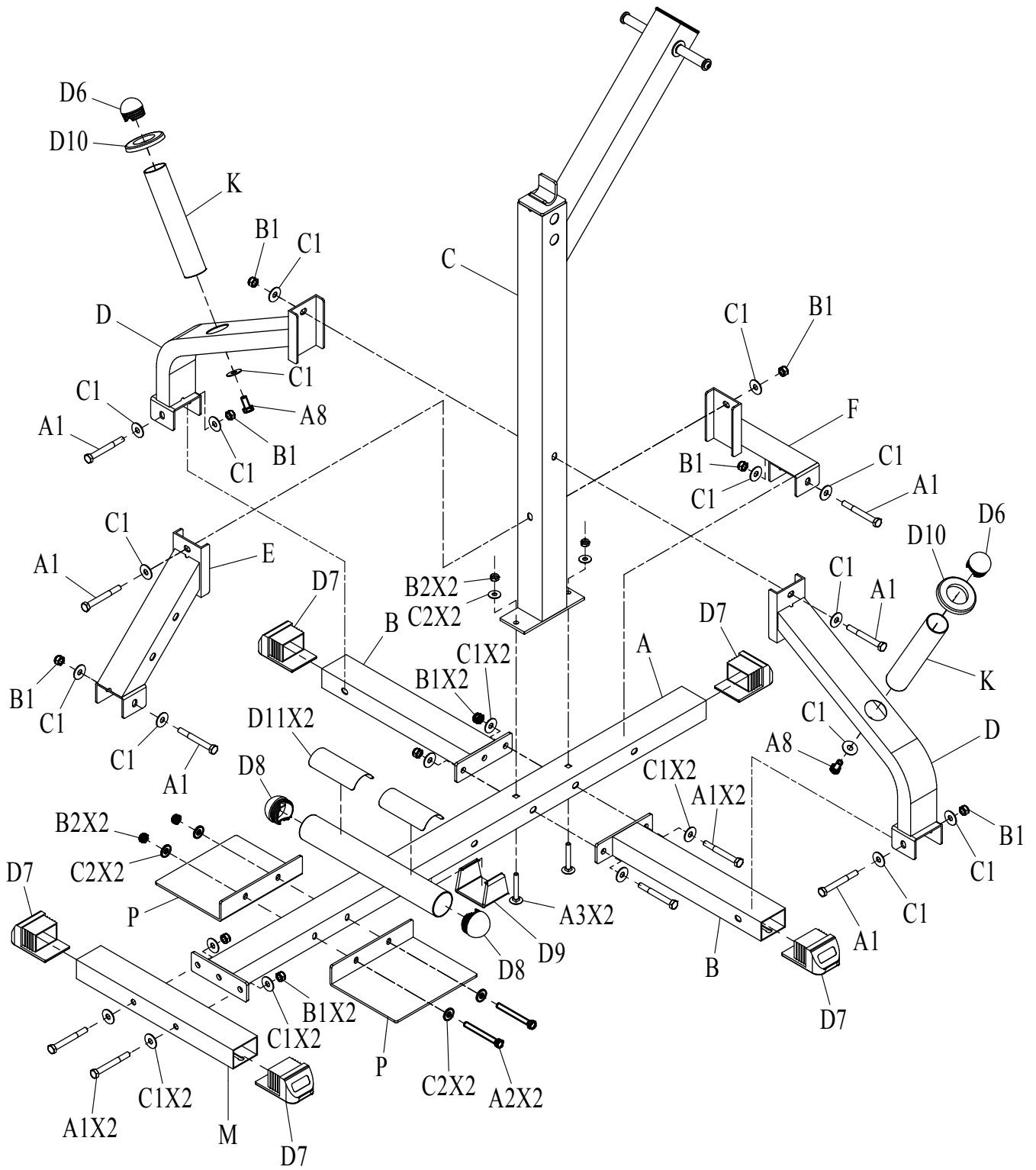

GSCL-360

Assembly Step 2

